



# West Grinstead Planting Project 2023-25

Finding space for nature in our Municipal  
Burial Ground



St Michael & All  
Angels Church



- 1. Meadow area**  
 Area to be left as long grass & native wildflower meadow. To be cut each Spring & Autumn only (clippings will be removed).
- 2. New Yew Tree**   
 To be planted as a small sapling, a slow growing tree which is traditional in a burial ground and can cope with the existing rough ground.
- 3. New Shrub area**  
 Native shrubs to be planted including hawthorn, dogrose, dogwood, hazel and alder buckthorn.
- 4. Small community orchard**   
 Traditional Sussex varieties of fruit tree to be planted in this area as a community orchard.
- 5. New bulb planting areas**   
 Native daffodils, snowdrops, primroses and crocus to be planted around the site.

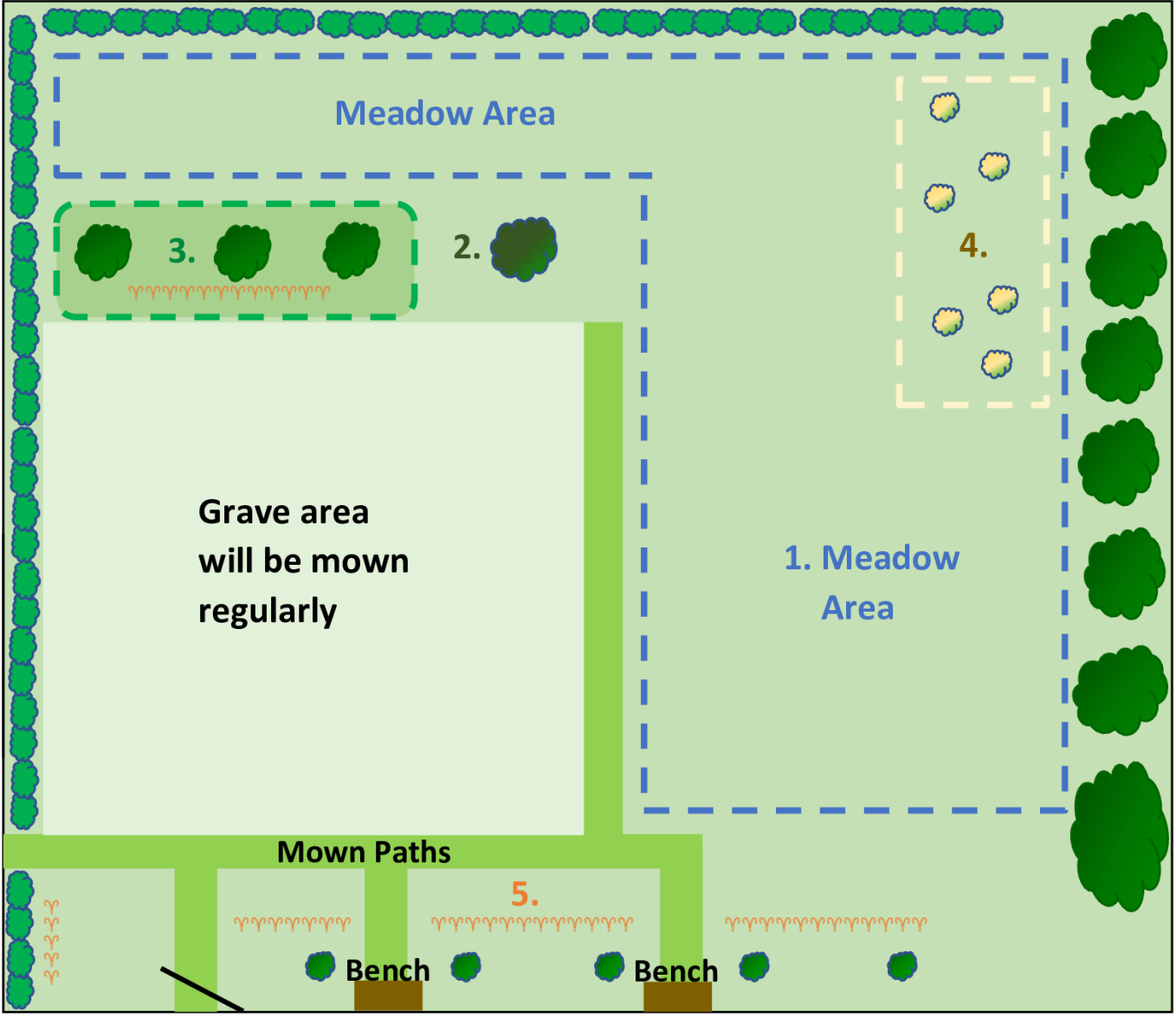

**Burial Ground Improvement Plan for Wildlife from May 2023**

There were already spring bulbs around the older graves, including snowdrops and daffodils.



Volunteers have planted more native daffodils and crocus along the southern area of the site.



We will be adding bluebells, plus more snowdrops and daffodils this year.

Last autumn volunteers planted a hedgerow using about 150 native saplings rescued from local gardens.

We had donations of hazel, hawthorn, blackthorn, dog rose, spindle berry, holly, dogwood, honeysuckle and field maple.

We hope to plant a second hedgerow on the southern boundary.



The meadow area will be left to grow until the flowers have set seed.

We will be cutting the hay and leaving it for a few days, so that the seeds can disperse.

The clippings will be raked up and removed, to reduce the fertility of the soil and make it more hospitable for Wild Flowers.





*Doctor Hogg*



*Coronation*

We will be planting  
a Community  
Orchard this year,  
selecting varieties  
of apple that were  
grown in Sussex



*Forge*



*First and Last*

# Next Steps

1. Planting some yew saplings and native shrubbery in the scrub area
2. Second hedgerow on southern fence boundary
3. Further tree planting
4. More bulbs to naturalise
5. Biodiversity mapping, to establish the baseline now and in the next few years, to check that what we are doing is making a difference.